

# SIMGASM

## Pro Simulator

Assembly Guide

---

Chassis / Pedal Deck / Wheel Mount

# CONTENTS

If you encounter any issues during the assembly, please reach out to us for a resolution in a timely manner.

01

## SYMBOL LEGEND

Pg. 02

02

## BUILD NOTES

Pg. 03

03

## PART LIST/ PACKING SLIP

Pg. 04

04

## ASSEMBLY INSTRUCTIONS

Pg. 05-14

### VISUAL SYSTEM

- Gold dots mark the exact fastener or slot to use.
- Leader arrows show important details.
- Short callout chips placed inside the visuals details where required.

# SYMBOL LEGEND

### IMPORTANT

- Open the hardware bags one at a time on a flat surface when needed.
- Leave adjustable hardware loose until the final seating position is confirmed.
- Check the packing slip and step pages before starting the assembly. After reading please start at step one and make sure no steps are skipped.



KEEP LOOSE



CHECK ORIENTATION



SLOTS INWARD



FLAT SIDE OUT



ADJUST HEIGHT



PRESS FIT

### REMINDER

- If you encounter any issue during the assembly, please reach out to us for a timely resolution.

# BUILD NOTES

Key references to follow before you tighten anything down.

## OVERVIEW

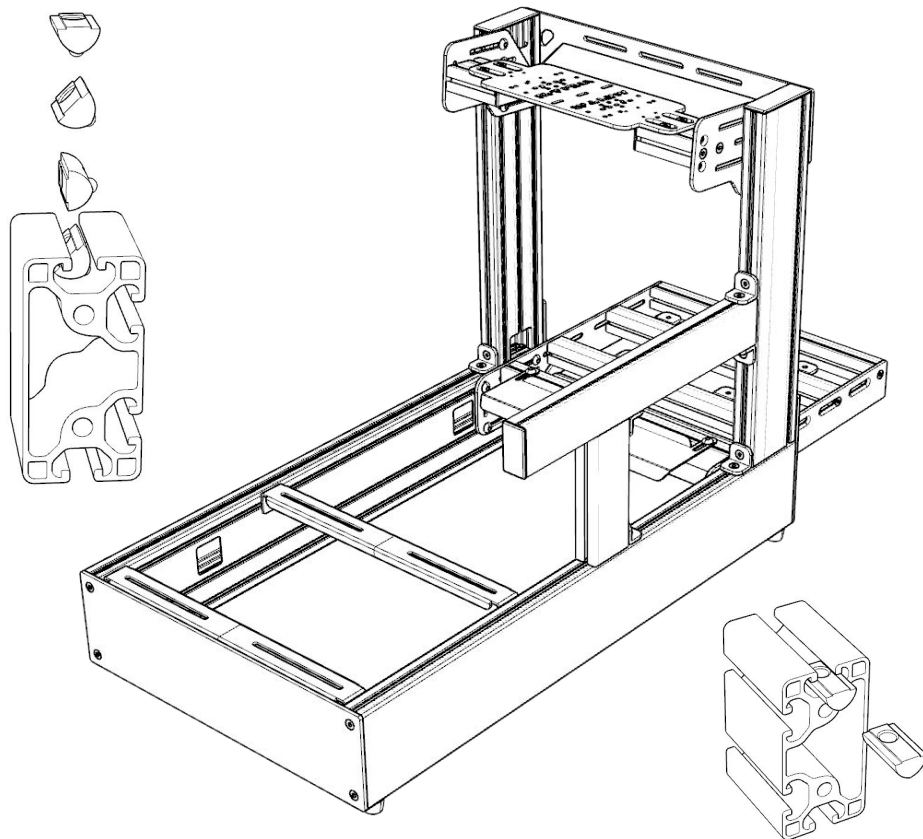

## BEFORE YOU START

- Work from the base up and keep adjustable hardware hand-tight until the final alignment pass.
- Pre-check pedal spacing before the pedal deck is fixed to the chassis.
- Wheel-mount height and angle are set last.
- You can press a T-nut sideways into a profile or slot it from an open end.

DETAIL- Inserting T-nuts through the slot

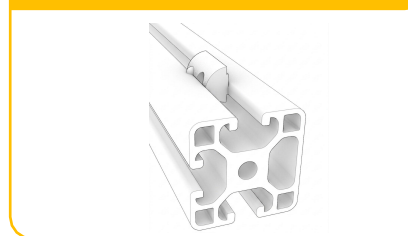

DETAIL- Twist after insert to lock

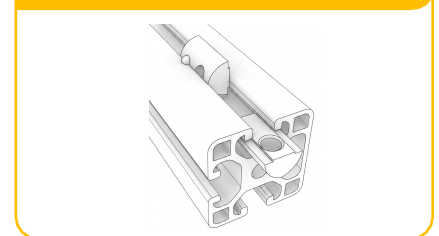

**BUILD ON A FLAT SURFACE**



**DO NOT FORCE HARDWARE**



**TIGHTEN AT END**



**CHECK ORIENTATION**

## REMINDER

- If you encounter any issue during the assembly, please reach out to us for a timely resolution.

# PART LIST / PACKING SLIP

Check the kit before assembly so the hardware stays grouped by build step.

## ASSEMBLY

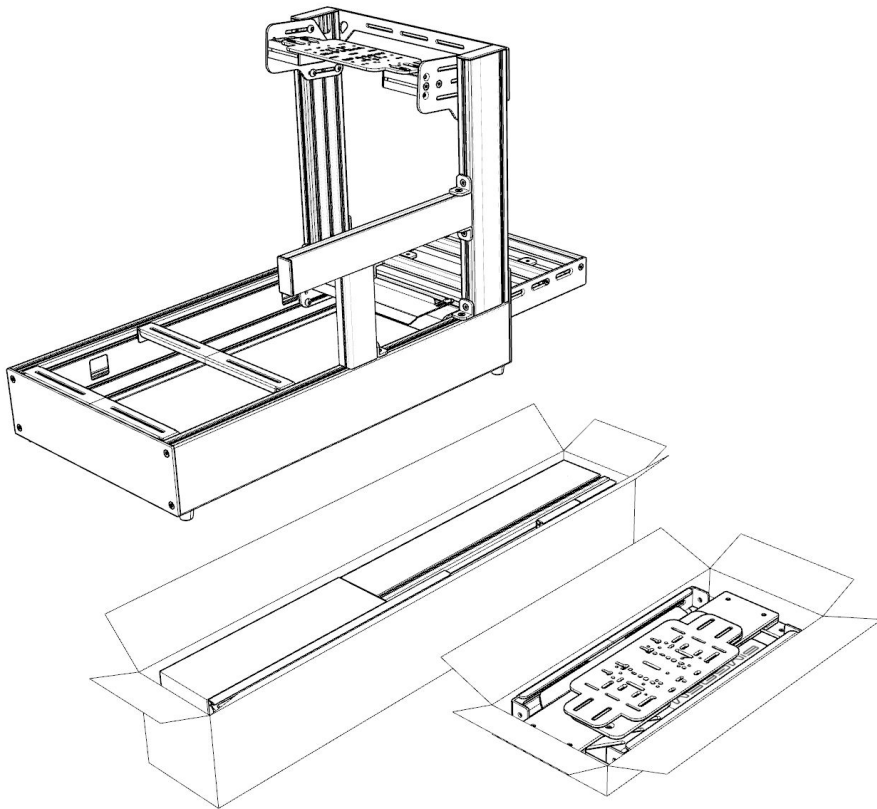

## COMPONENTS

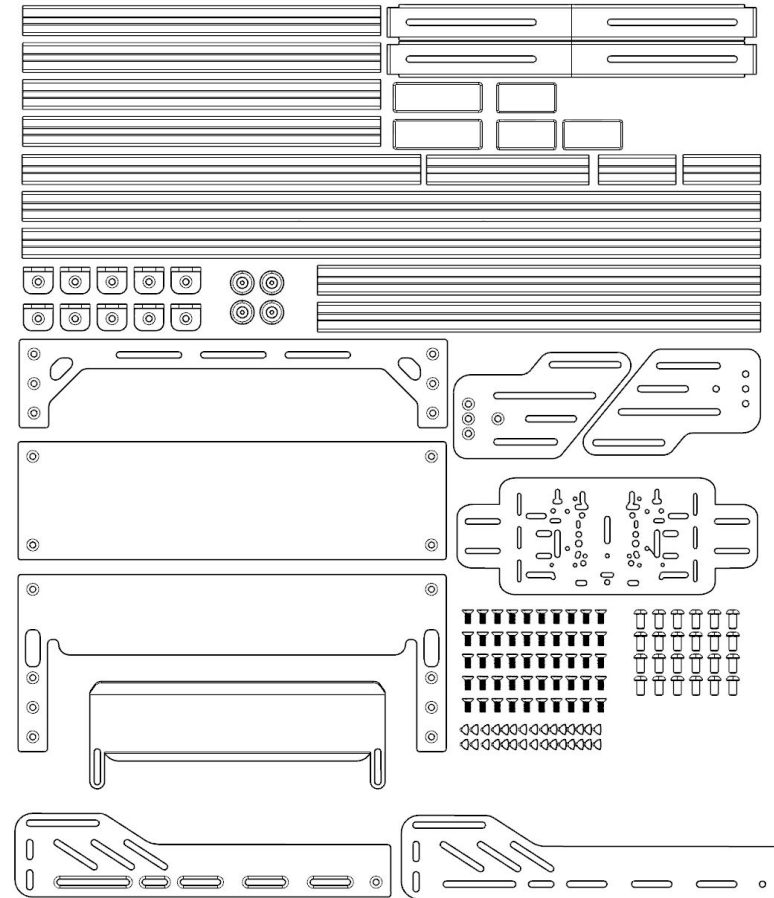

### REMINDER

Lay out the profiles, plates and hardware by step. This reduces the chance of missing a part later in the build.

01

# INSTALL THE RUBBER FEET

Start with the 100 cm base profiles and leave the hardware hand-tight.

## ASSEMBLY

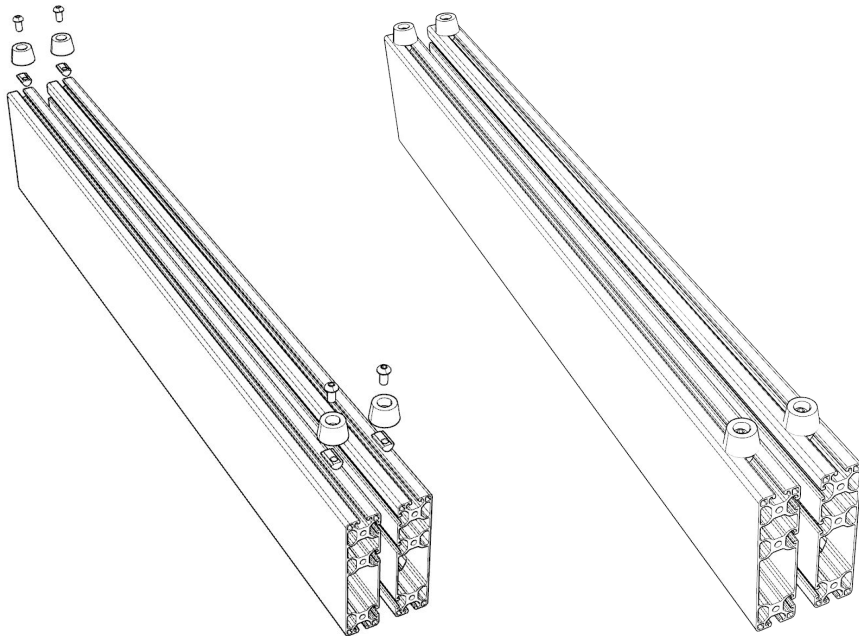

## RESULT

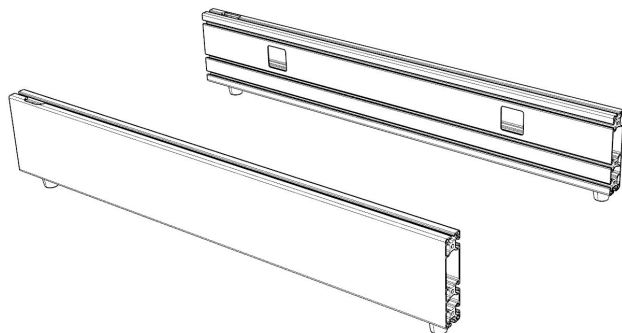

### PARTS - Parts for this step



### DETAIL - Push through the slot

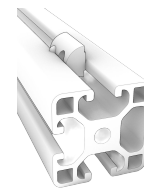

### DETAIL - Twist to lock

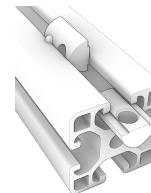

KEEP LOOSE



FLAT SIDE OUT



CHECK ORIENTATION

## ASSEMBLY

- Insert one M6 T-nut for each foot near the profile ends.
- Fit the rubber feet with the wide flat face against the profile.
- If the profile end is closed, push the T-nut through the slot sideways and twist it into position.

## PARTS REQUIRED

- 2x 100 cm profile
- Single plastic bag contents:
- 4x rubber feet
  - 4x M6 button head bolt
  - 4x M6 T-nut

## REMINDER

Keep the feet slightly inboard to avoid overhang after the end plates are fitted.

02

# FIT THE END PLATES

Close the base frame and confirm the profile faces before tightening.

## ASSEMBLY

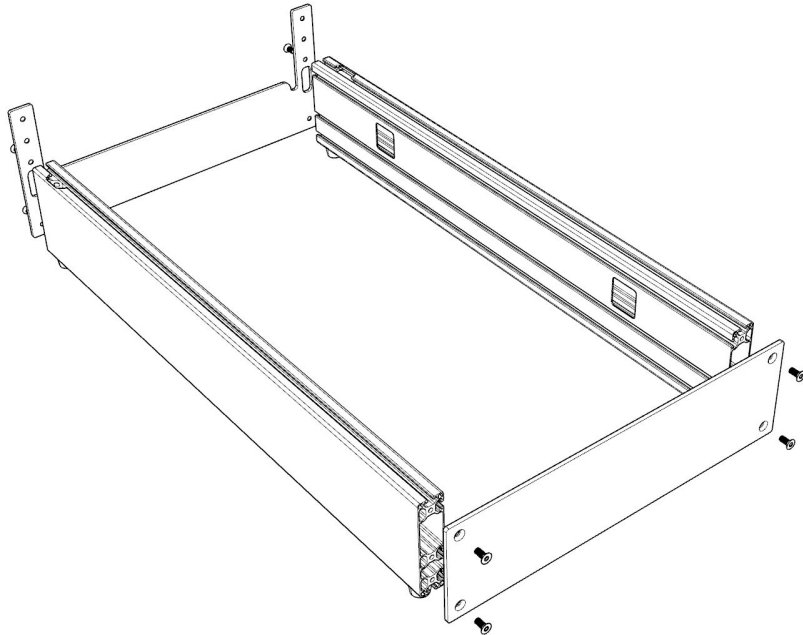

## RESULT

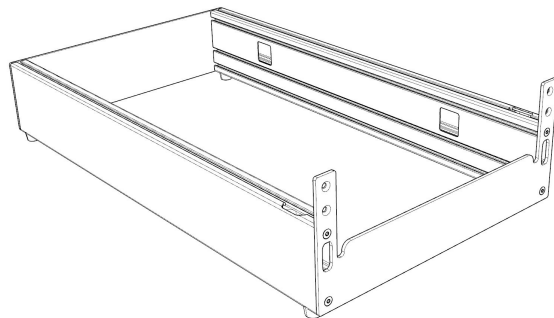

### PARTS - Parts for this step



### DETAIL - Profile orientation detail

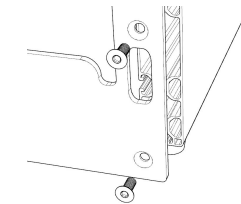

## ASSEMBLY

- Screw each countersunk bolt through the metal plate but do not fully tighten it yet. Once both bolts are in fully tighten the bracket with both bolts.
- Make sure the U shaped bracket is on the side with the slots on the top of the profile
- Keep the logo side of each profile facing outwards.
- The feet should sit on the flat surface when the base is upright.

## PARTS REQUIRED

- 2x end plates
- 8x countersunk bolt

## REMINDER

Confirm the SIMGASM logo plate faces the front of the chassis.

When you use power tools, do not overtighten these bolts. On a regular power tool setting 6-8 is sufficient.



FLAT SIDE OUT



CHECK ALIGNMENT

03

# INSTALL THE SEAT FRAME PLATES

Fit the cross brackets into the side slots and keep them adjustable.

## ASSEMBLY

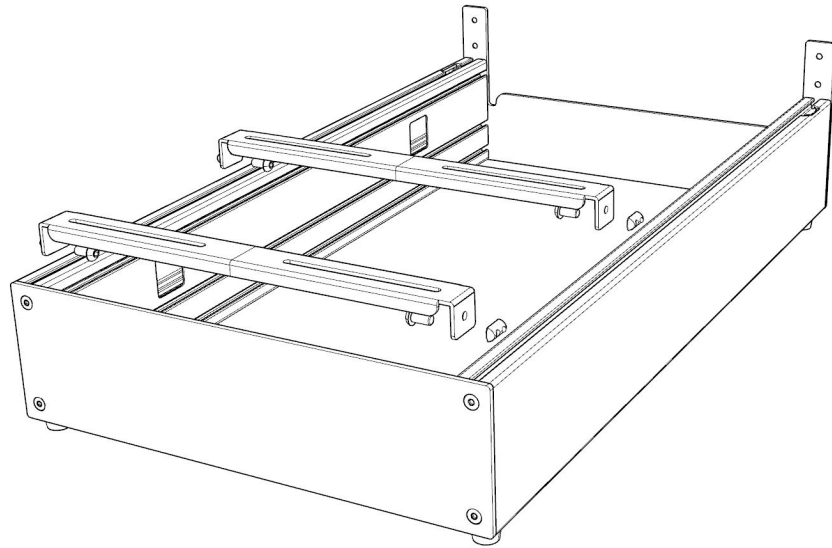

## RESULT

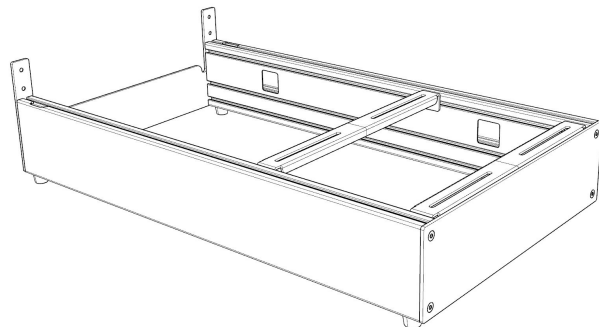

### PARTS - Parts for this step

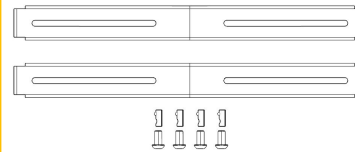

### DETAIL - Position the cross brackets

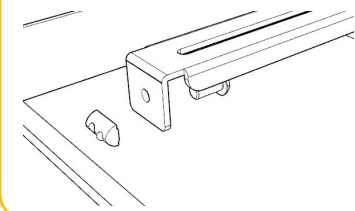

### DETAIL - Button head bolt fit

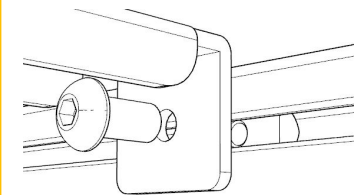

## ASSEMBLY

- Add 2x T-nuts per side to the chassis top side slots.
- Keep both cross brackets loose until the final seat position and bolt pattern of your seat is known.
- If you have a seat slider check the distance required to mount these on the cross brackets.

## PARTS REQUIRED

- 2x cross bracket
- 4x T-nut
- 4x m8x16 button head bolt

## REMINDER

Use the slotted side of each bracket for later seat-position adjustment.



# 04 INSTALL THE UPRIGHTS

Bolt the 60 cm profiles to the base frame with the most slots facing inward.

## ASSEMBLY

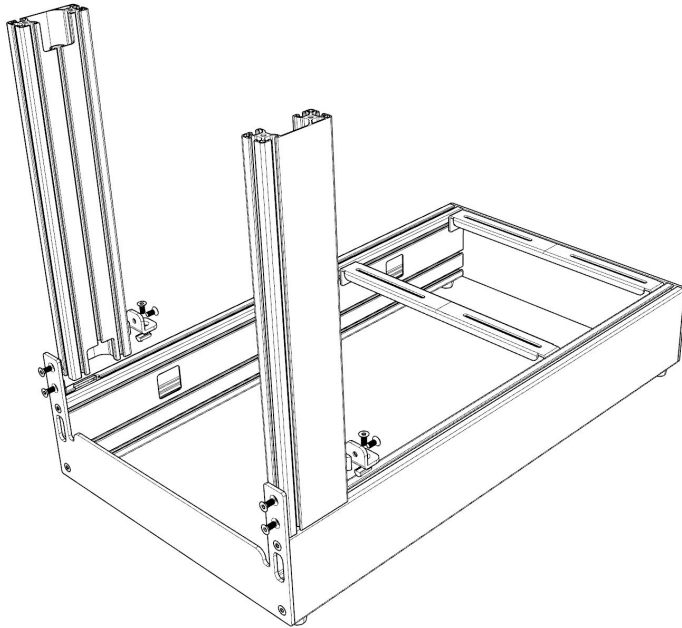

## RESULT

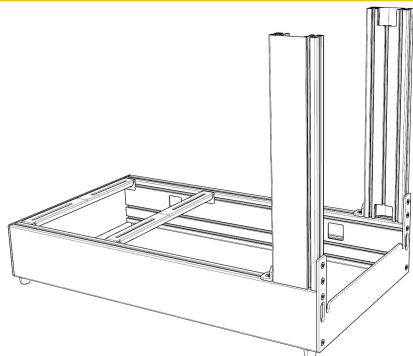

### PARTS - Parts for this step

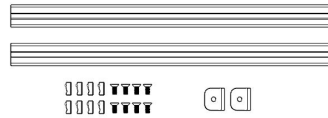

### DETAIL - Bracket and T-nut position

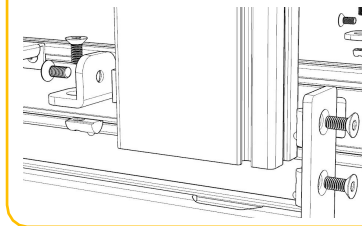

## ASSEMBLY

- Have the profile with the most slots of each upright profile facing inward, toward the centre of the base frame and the outside slot facing the shortest end (front side) of the chassis.
- Set both uprights square before tightening the corner brackets.

## PARTS REQUIRED

- 2x 60 cm profile 6 slots
- 2x corner bracket
- 8x countersunk bolt
- 8x T-nut

## REMINDER

Leave the uprights adjustable until the brace plate and wheel mount are installed.



**MOST SLOTS INWARD**



**KEEP LOOSE**



**CHECK ALIGNMENT**

05

# ATTACH THE SHIFTER ARM

Mount the 54 cm shifter arm to the preferred side of the chassis.

## ASSEMBLY

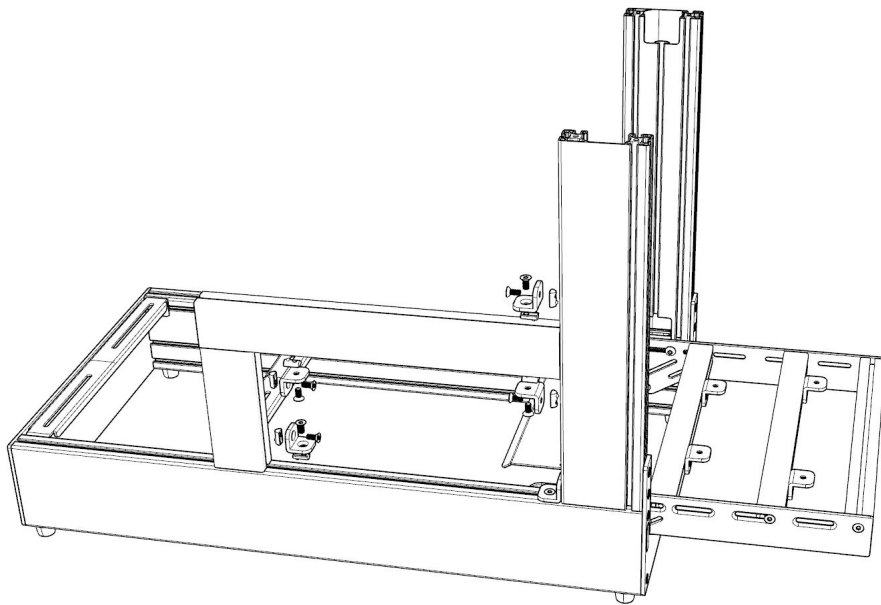

## RESULT

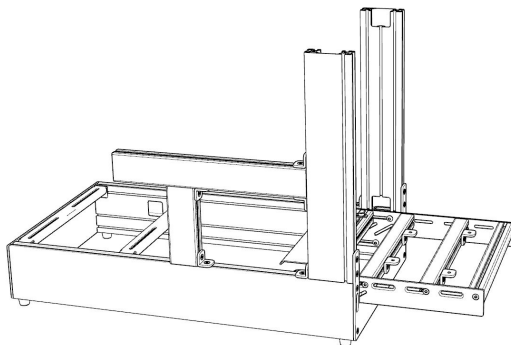

### PARTS - Parts for this step



### DETAIL - Shifter arm bracket stack

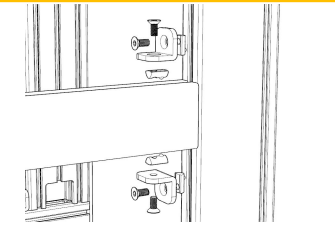

## ASSEMBLY

- Mount the shifter arm on the left or right side of the base.
- Keep the 2-slot face inward unless you need accessories on the outside.
- Depending on your needs the profile can be mounted in any orientation.
- To avoid clearance issues with the seat, the horizontal bar can slide further inwards.

## PARTS REQUIRED

- 1x 54 cm profile (shifter arm)
- 1x 22 cm profile (support arm)
- 3x corner bracket
- 6x countersunk bolt
- 6x T-nut

## REMINDER

Match the shifter arm height to the later seat and wheel position.



OPTIONAL SIDE



CHECK ORIENTATION

06

# ASSEMBLE THE PEDAL DECK

Build the pedal tray and set the profile spacing to suit your pedals.

## ASSEMBLY

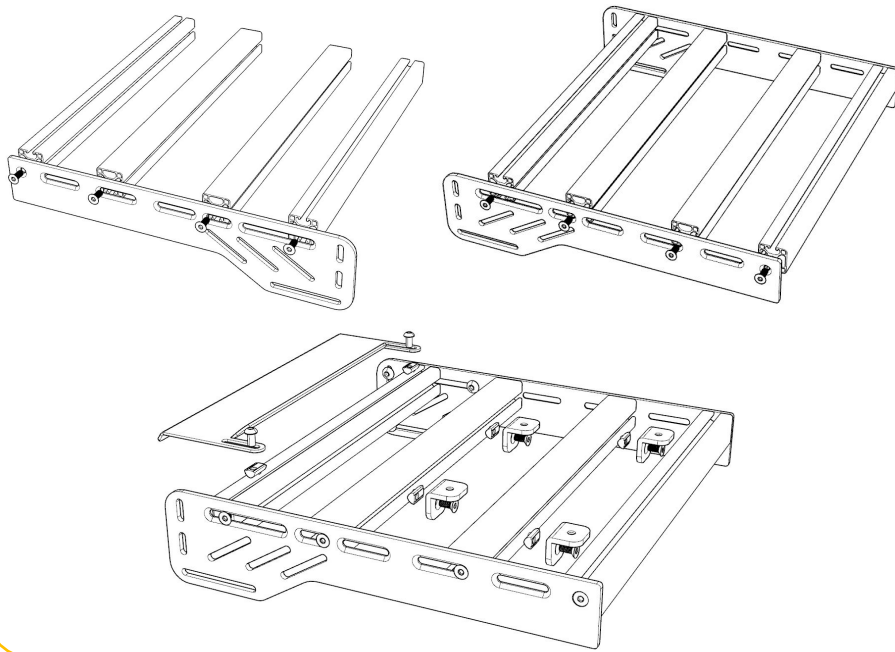

## RESULT

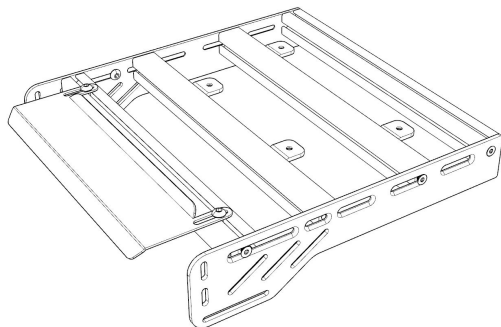

### PARTS - Parts for this step

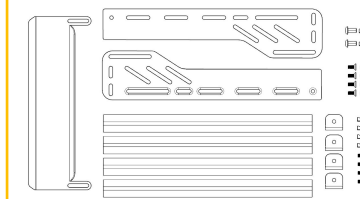

### DETAIL - Pedal assembly

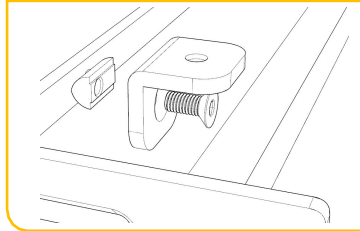

## ASSEMBLY

- Set the 4 profile positions to suit your pedal set before final tightening the side brackets.
- Where possible, keep the closed side of the profiles facing up to avoid dust accumulation over time
- T-nuts can be used in the profiles to bolt directly through pedal sets or the corner brackets can be used to mount pedals from the bottom.

## PARTS REQUIRED

- 2x pedal bracket
  - 4x 48.4 cm profile
  - 8x countersunk bolt
- Optional:
- 4x corner bracket
  - 6x T-nut
  - 4x counter sunk bolt
  - 2x m8x16 button head bolt
  - 1x heel rest



CHECK ORIENTATION



KEEP LOOSE

## REMINDER

Leave enough slot travel for the final pedal spacing adjustment.

07

# MOUNT THE PEDAL DECK

Fix the pedal tray to the chassis and adjust the height and angle.

## ASSEMBLY

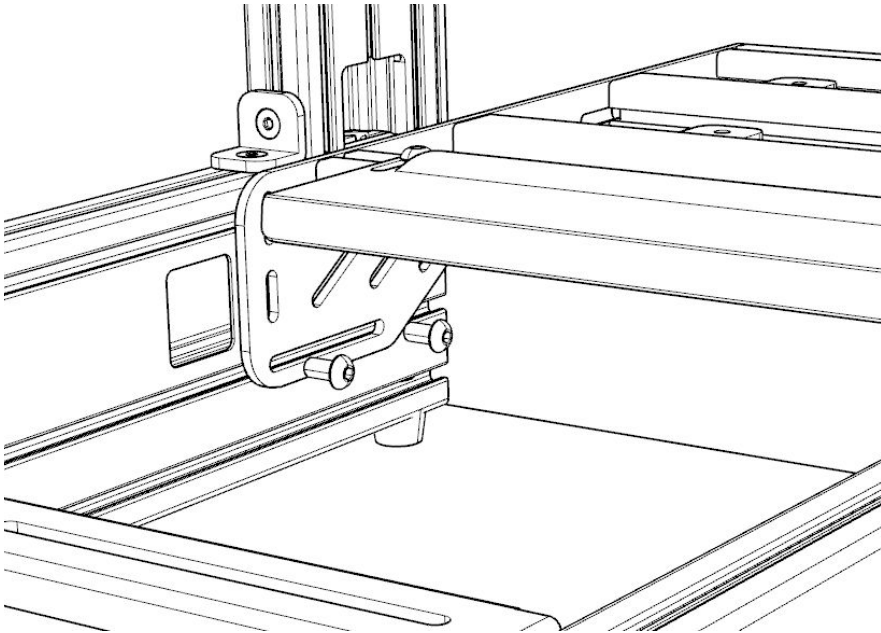

## RESULT

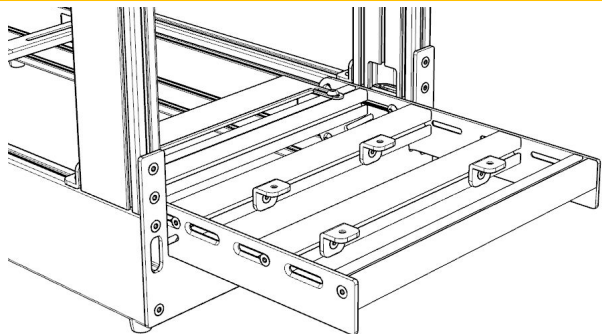

### PARTS - Parts for this step

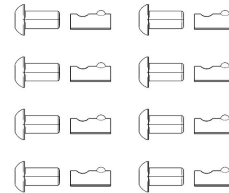

### DETAIL - Bolt position

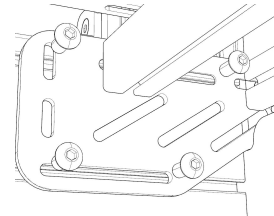

## ASSEMBLY

- Use the upright and/or base slots to set desired deck height and angle before tightening.
- Insert the T-nuts at desired slots
- Place pedal assembly as a whole from the front through the frame and hand tighten all bolts before fully tightening all bolts.

## PARTS REQUIRED

- 8x T-nut
- 8x m8x16 button head bolt

## REMINDER

For best stiffness, use at least 4 bolts per side into the base frame/upright or when the pedal plate is resting on the front plate.

TIP: Install your peripherals for easier access before installing the deck to the chassis.



CHECK ALIGNMENT



ADJUST HEIGHT / ANGLE



TIGHTEN AT END

08

# INSTALL THE BRACE PLATE

Span the uprights and set the wheel support height before final tightening.

## ASSEMBLY

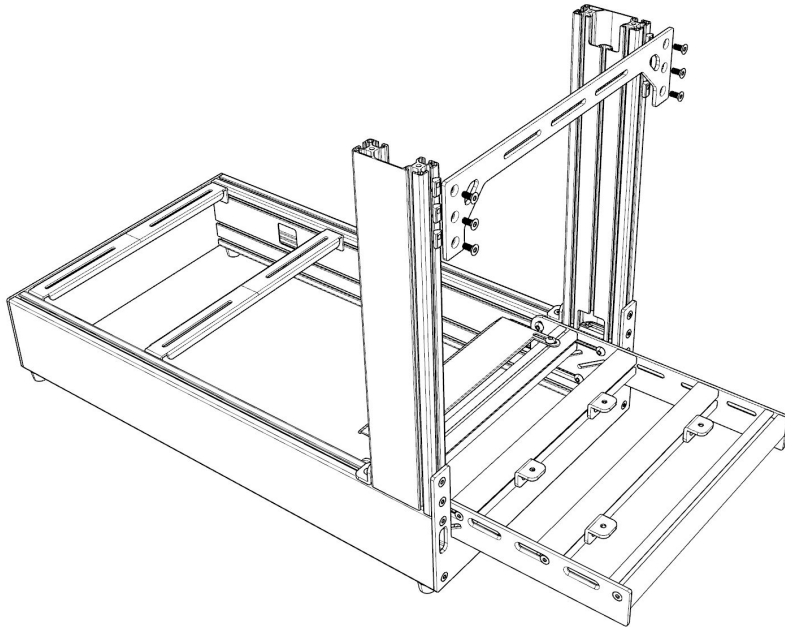

## RESULT

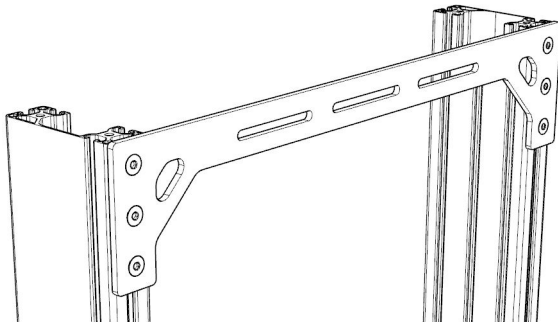

### PARTS - Parts for this step



## ASSEMBLY

- Set the brace plate height to suit your wheel position.
- The brace plate can be inverted if that gives a better wheel-mount layout.
- This brace can be used as a mounting point for your PC Shelf Add-On.

## PARTS REQUIRED

- 1x brace plate
- 6x T-nut
- 6x countersunk bolt

## REMINDER

Check the height and orientation again with the wheel mount before you fully tighten the upright bolts. It can be mounted upside down or lower if you require more clearance behind the wheel deck.



ADJUST HEIGHT



OPTIONAL ORIENTATION

## 09

# CONFIGURE THE WHEEL MOUNT

Choose the mount option that matches your wheelbase and driving position.

## MOUNT OPTIONS

Choose the wheel mount that matches your wheelbase. The labels below correct the earlier front/bottom swap.

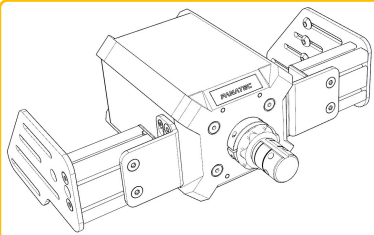

**SIDE MOUNT**  
Bracket on wheel sides

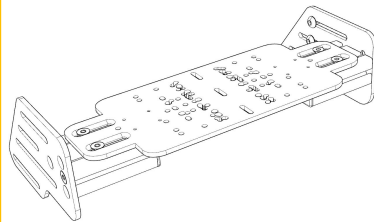

**BOTTOM MOUNT**  
Plate under wheelbase

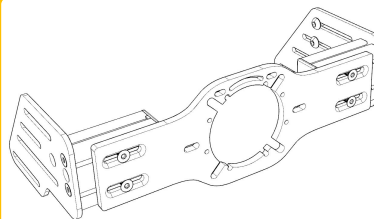

**FRONT MOUNT**  
Plate in front

DETAIL - Assembly side wheel mount plate to chassis

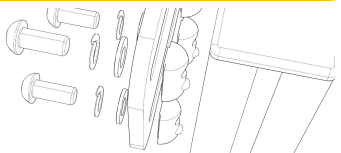

DETAIL - Assembly washers on button head bolt

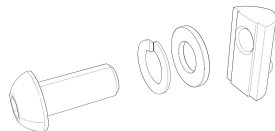

PARTS - Parts for this step

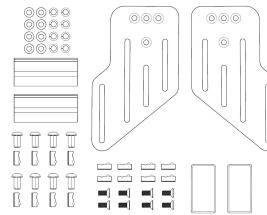

DETAIL - Assembly front and side wheel mount

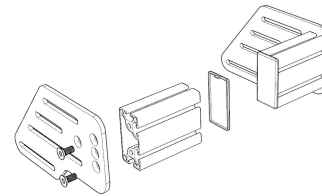

DETAIL - Assembly bottom wheel mount

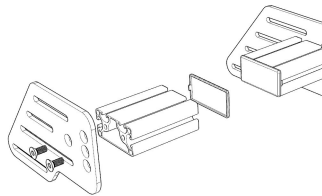

CHOOSE MOUNT OPTION



CHECK ALIGNMENT



TIGHTEN AT END

## ASSEMBLY

- Choose the mount style that matches your wheelbase. Side and Front, use the bottom and top holes of the side plate, bottom use the middle holes.
- For the side mount, bolt the side brackets to your motor first to avoid accessibility issues when mounting the motor at a later stage.
- Insert the T-nuts in the uprights and bolt it down with the bolts through the metal plates after attaching the metal plates to the profiles.

## PARTS REQUIRED

- 2x 10.5 cm profile
- 12x T-nut
- 2x adjustable bracket
- 8x countersunk bolt
- 8x m8x20 button head bolt
- 2x end cap
- 8x spring washer
- 8x flat washer

## REMINDER

After final height and angle are set, retighten all 8 upright bolts.

# 10 INSTALL THE END CAPS

Finish the chassis and complete the final alignment check.

## ASSEMBLY

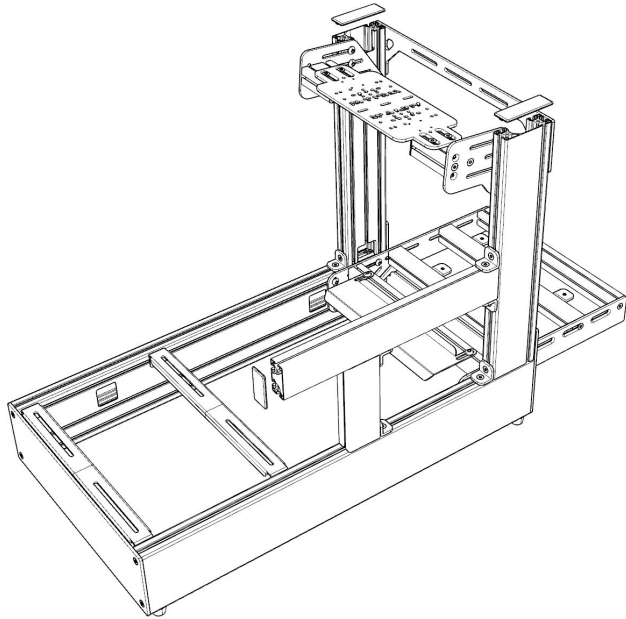

## RESULT

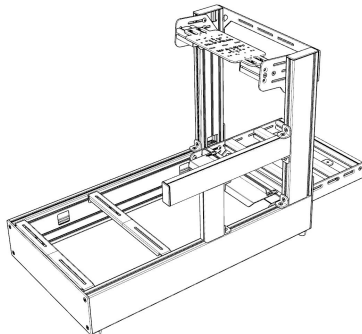

### PARTS - Parts for this step

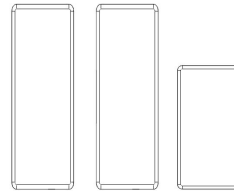

### DETAIL - Installation of end cap on upright

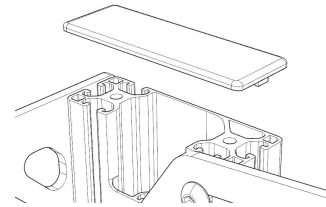

## ASSEMBLY

- Push each cap by hand until it is fully seated and avoid tapping it with tools to sit flush.
- Complete a final alignment and hardware check before use.
- Your SIMGASM Pro Simulator chassis is now ready for pedal and wheel base setup.

## PARTS REQUIRED

- 2x end cap 12cm
- 1x end cap 8cm

## REMINDER

Tighten the shifter arm, pedal deck and wheel support once you confirm your final seating position.

TIP: pull your wiring through the chassis prior of installing the end caps on the upright for better access.



PRESS FIT



FINAL CHECK

# 01 Optional - Seat Sliders

Add the seat slider to the chassis.

## ASSEMBLY

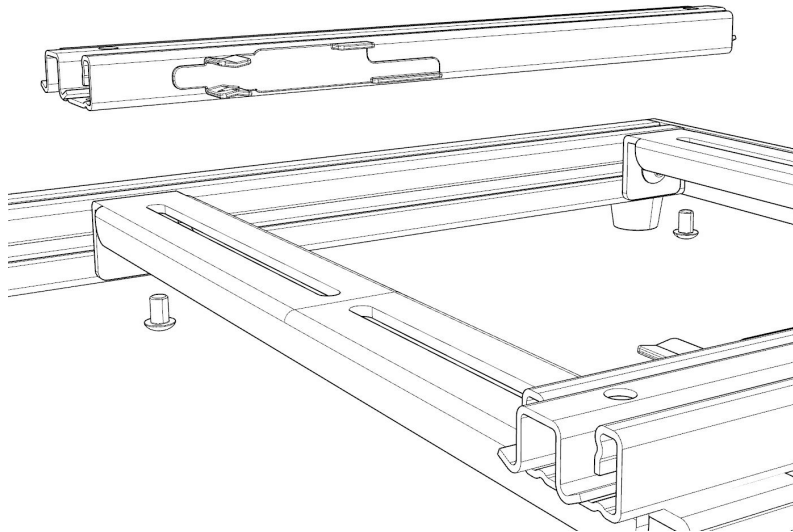

## RESULT

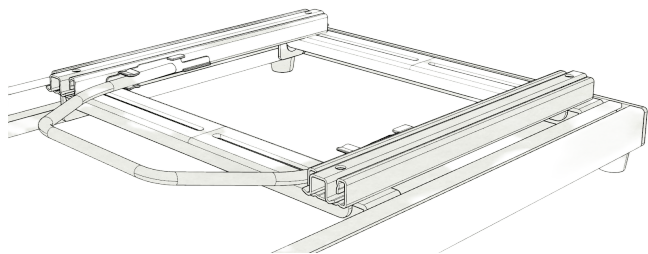

## DETAIL

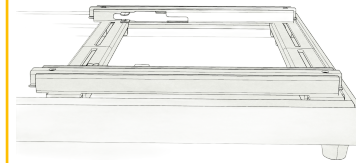

## ASSEMBLY

- Place each slider on top of the cross brackets and align the nut in front of the slotted brackets.
- Ensure the release mechanism is facing inwards on both sides and the pin is facing the backside of the chassis with the U shaped bracket facing forward.
- Bolt goes from the bottom into the slider directly.

## PARTS REQUIRED

- 1x seat slider set
- 1x slider handle
- 4x m8x12 bolt

## REMINDER

Fully tighten the sliders once both are square and functional for adjusting the seating position.



FLAT SIDE OUT



CHECK ALIGNMENT



TIGHTEN AT END

02

# Optional - Seat Brackets

Add the seat brackets to the slider.

## ASSEMBLY

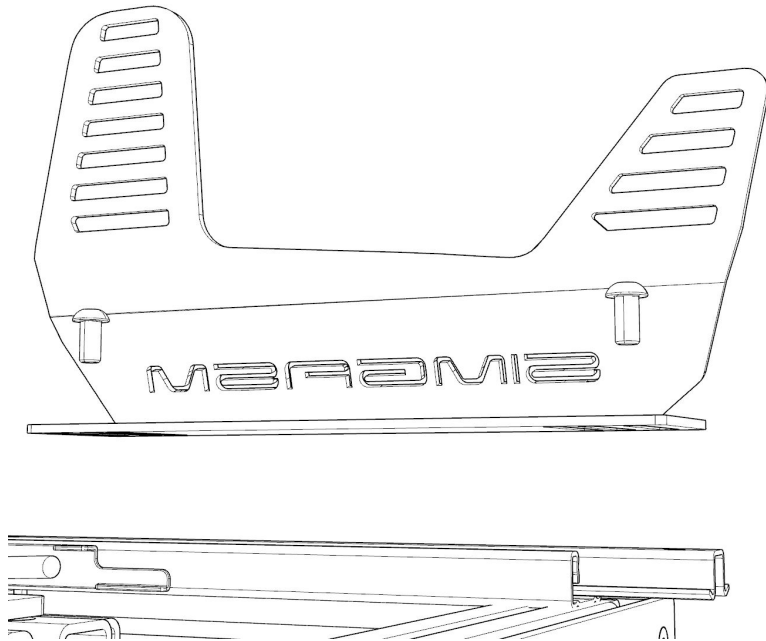

## RESULT

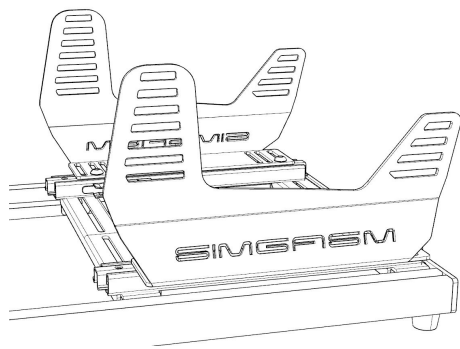

CHECK ALIGNMENT



TIGHTEN AT END

## ASSEMBLY

- Place each bracket on top of the slider and align the nut in front of the slotted brackets.
- Bolt goes from the top into the slider directly without the need of an additional nut.
- Alternatively you can move the slider from front to back and insert a regular nut underneath the slot and tighten the bolt from above.

## PARTS REQUIRED

- 1x seat bracket set
- 4x m8x12 bolt
- Optional: 4x m8 nut

## REMINDER

Fully tighten the brackets once both are square and at the right distance for your desired seat.

02

# Optional - Core seat

Install the Core seat to the slider

## ASSEMBLY

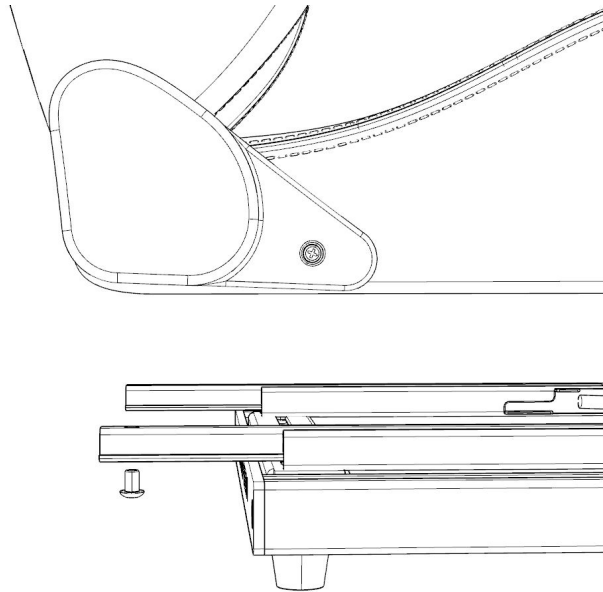

## RESULT

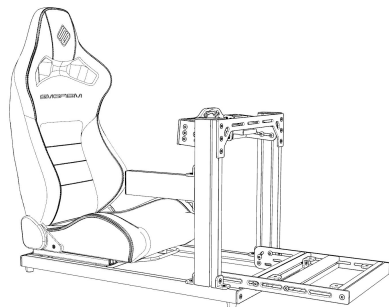

## DETAIL

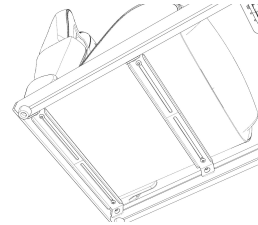

## ASSEMBLY

- To bolt bottom mounted Core seats directly onto the slider, slide the seat rails back and insert the bolt from the bottom directly into the seat and tighten it.
- Same for the front side however then slide the seat slider forward.
- If you don't use a slider, the seat bolts directly through the cross bracket.

## PARTS REQUIRED

- 1x SIMGASM Core seat
- 4x m8x16 bolt

## REMINDER

Fully tighten the brackets once both are square and at the right distance for your desired seat.



CHECK ALIGNMENT



TIGHTEN AT END